

INSTALLATION AND SERVICE MANUAL

For Installation of Funen 3,4 Underwater projectors, floodlights RGBW.
Model. UFUN-50022 and UFUN-50032

Product drawing (dimensions)

CE IP68 IK07 CLASS III Q0.3m

! For use only when immersed in water

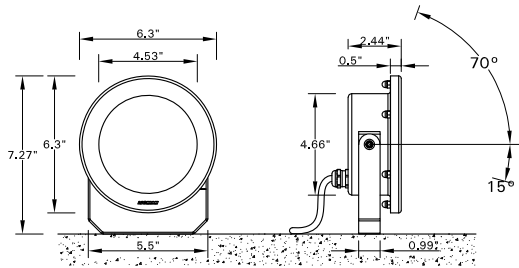

UFUN-50022

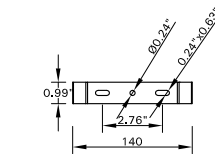

MOUNTING DETAIL

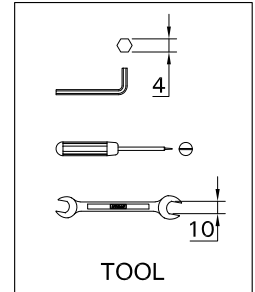

TOOL

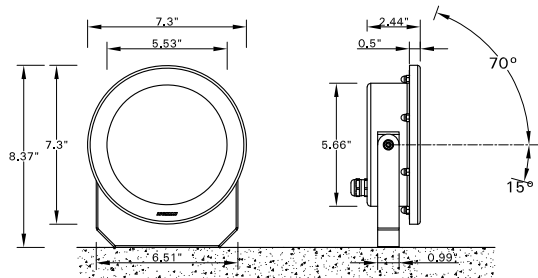

UFUN-50032

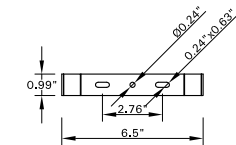

MOUNTING DETAIL

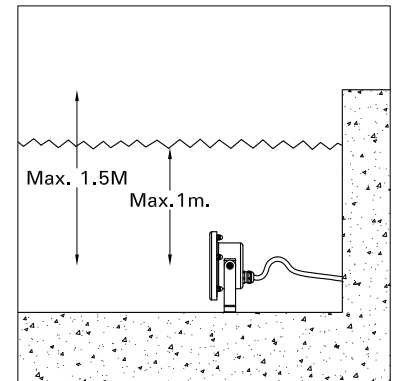

WIRING DIAGRAM LUMAIRES

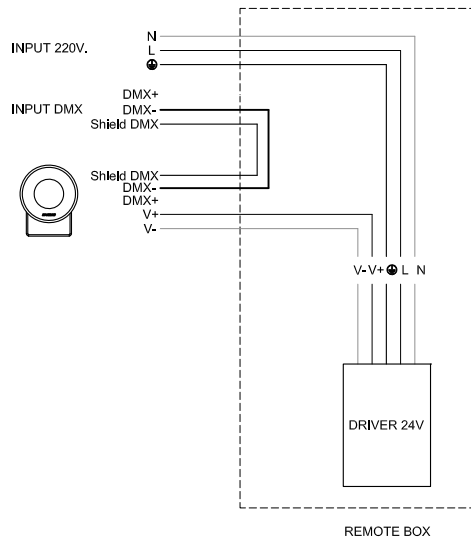

REMOTE BOX

1

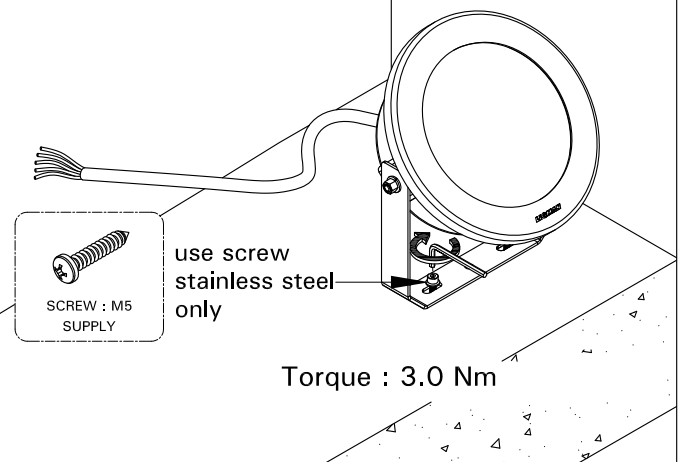

- LIGMAN standard products are supplied with the control gear 24Vdc.
The control gear for other voltages and frequencies is available upon request, please consult us for more details.
- LIGMAN luminaires are designed to conform IEC 60598 2-18 standard.
Technical amendments and modifications techniques reserved.

Ligman Lighting USA

7144 NE Progress Court, Hillsboro
Oregon, 97124, USA
Tel : 503 645 0500 | Fax : 503 645 8100

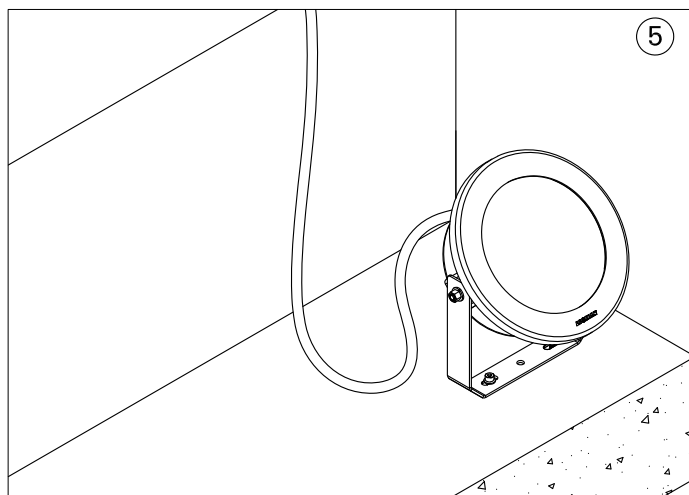
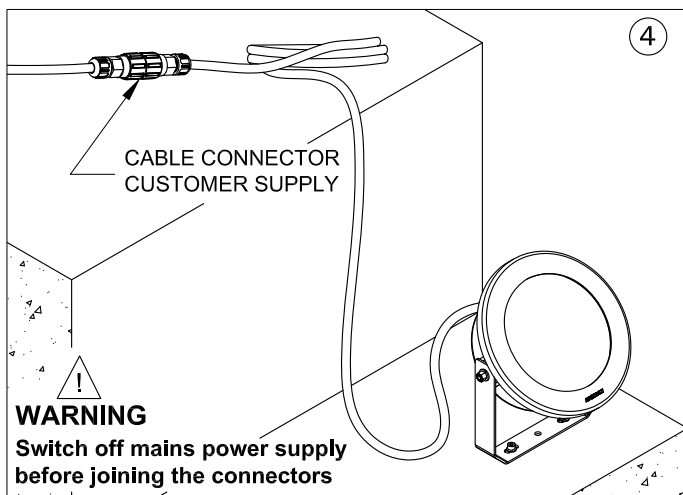
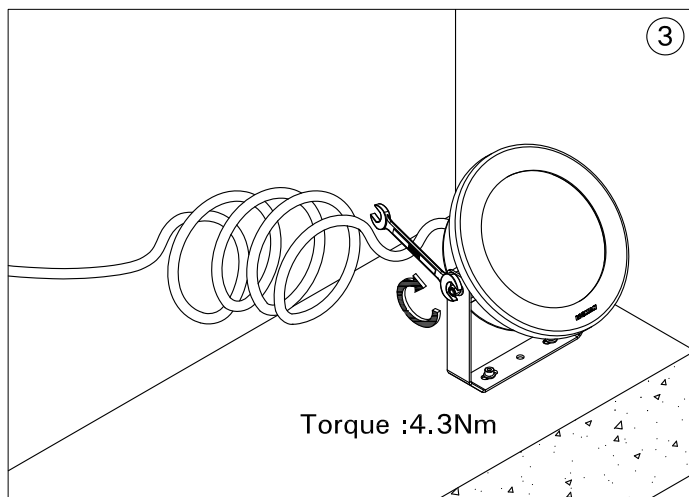
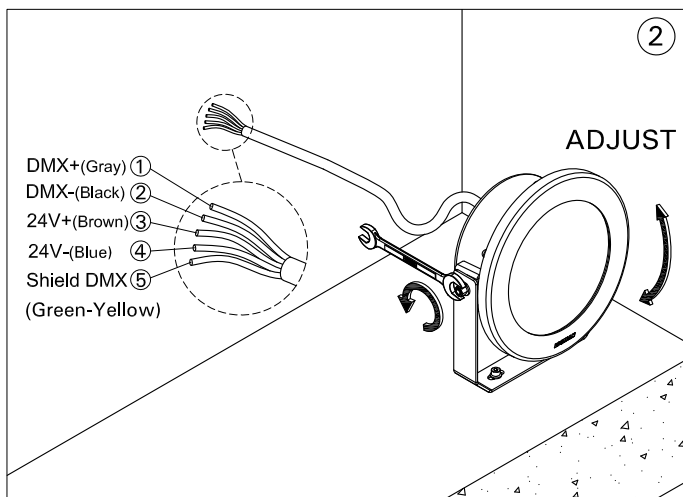

WIRING DIAGRAM RGBW SYSTEM

